

ROOF PLAN

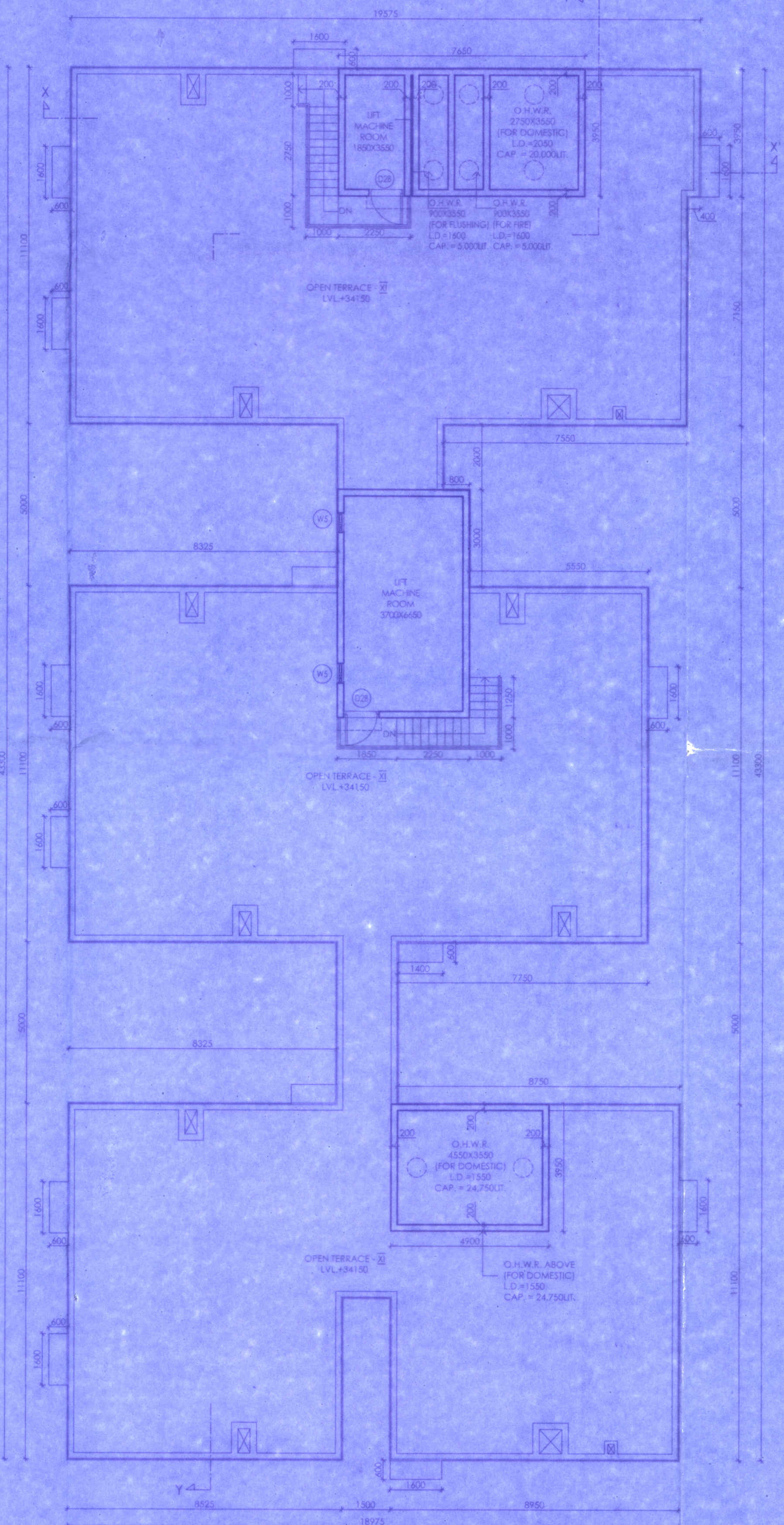

ABOVE ROOF PLAN

PROJECT																																																									
PROPOSED 1 NOS. B+G+X STORED & 1NO. B+G+1X STORED RESIDENTIAL BUILDINGS. ADDRESS - KHAGBARA BEHO WBSEDCCL Substation. NH, 17, COOCHBEHAR WB. HOUDA - KHAGBARA PLNO: 99 SHEET NO: 2 L.F. KHARAN NO: 13774 - 14216 L.P. NO: 2754, 2755, 2756, 2757, 2758, 2759, 2760, 2761, 3335, 3336, 3340, 3350, 3351, 3353, 2761, 2647, 2750, 2647, 2648, 2661, 2664, 2668, 2669, 2672, 2685, 2686, 2644, 2749, 2662, 2663 & 2665, 2666, 2667, 2668, 2669, 2670, 2671, 2672, 2673, 2674, 2675, 2676, 2677, 2678, 2679, 2680, 2681, 2682, 2683, 2684, 2685, 2686, 2687, 2688, 2689, 2690, 2691, 2692, 2693, 2694, 2695, 2696, 2697, 2698, 2699, 2700, 2701, 2702, 2703, 2704, 2705, 2706, 2707, 2708, 2709, 2710, 2711, 2712, 2713, 2714, 2715, 2716, 2717, 2718, 2719, 2720, 2721, 2722, 2723, 2724, 2725, 2726, 2727, 2728, 2729, 2730, 2731, 2732, 2733, 2734, 2735, 2736, 2737, 2738, 2739, 2740, 2741, 2742, 2743, 2744, 2745, 2746, 2747, 2748, 2749, 2750, 2751, 2752, 2753, 2754, 2755, 2756, 2757, 2758, 2759, 2760, 2761, 2762, 2763, 2764, 2765, 2766, 2767, 2768, 2769, 2770, 2771, 2772, 2773, 2774, 2775, 2776, 2777, 2778, 2779, 2780, 2781, 2782, 2783, 2784, 2785, 2786, 2787, 2788, 2789, 2790, 2791, 2792, 2793, 2794, 2795, 2796, 2797, 2798, 2799, 2800, 2801, 2802, 2803, 2804, 2805, 2806, 2807, 2808, 2809, 2810, 2811, 2812, 2813, 2814, 2815, 2816, 2817, 2818, 2819, 2820, 2821, 2822, 2823, 2824, 2825, 2826, 2827, 2828, 2829, 2830, 2831, 2832, 2833, 2834, 2835, 2836, 2837, 2838, 2839, 2840, 2841, 2842, 2843, 2844, 2845, 2846, 2847, 2848, 2849, 2850, 2851, 2852, 2853, 2854, 2855, 2856, 2857, 2858, 2859, 2860, 2861, 2862, 2863, 2864, 2865, 2866, 2867, 2868, 2869, 2870, 2871, 2872, 2873, 2874, 2875, 2876, 2877, 2878, 2879, 2880, 2881, 2882, 2883, 2884, 2885, 2886, 2887, 2888, 2889, 2890, 2891, 2892, 2893, 2894, 2895, 2896, 2897, 2898, 2899, 2900, 2901, 2902, 2903, 2904, 2905, 2906, 2907, 2908, 2909, 2910, 2911, 2912, 2913, 2914, 2915, 2916, 2917, 2918, 2919, 2920, 2921, 2922, 2923, 2924, 2925, 2926, 2927, 2928, 2929, 2930, 2931, 2932, 2933, 2934, 2935, 2936, 2937, 2938, 2939, 2940, 2941, 2942, 2943, 2944, 2945, 2946, 2947, 2948, 2949, 2950, 2951, 2952, 2953, 2954, 2955, 2956, 2957, 2958, 2959, 2960, 2961, 2962, 2963, 2964, 2965, 2966, 2967, 2968, 2969, 2970, 2971, 2972, 2973, 2974, 2975, 2976, 2977, 2978, 2979, 2980, 2981, 2982, 2983, 2984, 2985, 2986, 2987, 2988, 2989, 2990, 2991, 2992, 2993, 2994, 2995, 2996, 2997, 2998, 2999, 3000.																																																									
GENERAL NOTES																																																									
1. ALL DIMENSIONS ARE IN MM. 2. ALL EXTERNAL WALLS ARE 200 THK. & INTERNAL WALLS ARE 100 THK. UNLESS OTHERWISE MENTIONED. 3. ALL MASONRY WORKS ARE BOUND BY CEILING WORKS (1:1) & (1:4). 4. EXTERNAL PLASTER IS 25 THK. & INTERNAL PLASTER IS 12 MM. THK. & CEILING PLASTER IS 10 MM. THK. WITH THERMOPLASTER. 5. ALL DOORS TO BE AS PER SPEC.																																																									
SCHEDULE OF DOORS	SCHEDULE OF WINDOWS																																																								
<table border="1"> <thead> <tr> <th>NO.</th> <th>SILL</th> <th>LINTEL</th> <th>SIZE</th> </tr> </thead> <tbody> <tr> <td>D1</td> <td>7140</td> <td>1500X2150</td> <td>W1 900 2150 1500X1250</td> </tr> <tr> <td>D2</td> <td>2150</td> <td>1100X2150</td> <td>W2 900 2150 900X1250</td> </tr> <tr> <td>D3A</td> <td>2150</td> <td>1100X2150</td> <td>W3A 900 2150 1025X1250</td> </tr> <tr> <td>D3B</td> <td>100</td> <td>2250</td> <td>1100X2150</td> </tr> <tr> <td>D3C</td> <td>2150</td> <td>900X2150</td> <td>W4 900 2150 600X1250</td> </tr> <tr> <td>D4</td> <td>2150</td> <td>800X2150</td> <td>W5 300 2400 900X1700</td> </tr> <tr> <td>D4A</td> <td>2150</td> <td>600X2150</td> <td>W6 300 2400 900X2100</td> </tr> <tr> <td>D5</td> <td>2150</td> <td>750X2150</td> <td>W 1550 2150 600X600</td> </tr> </tbody> </table>	NO.	SILL	LINTEL	SIZE	D1	7140	1500X2150	W1 900 2150 1500X1250	D2	2150	1100X2150	W2 900 2150 900X1250	D3A	2150	1100X2150	W3A 900 2150 1025X1250	D3B	100	2250	1100X2150	D3C	2150	900X2150	W4 900 2150 600X1250	D4	2150	800X2150	W5 300 2400 900X1700	D4A	2150	600X2150	W6 300 2400 900X2100	D5	2150	750X2150	W 1550 2150 600X600	<table border="1"> <thead> <tr> <th>NO.</th> <th>SILL</th> <th>LINTEL</th> <th>SIZE</th> </tr> </thead> <tbody> <tr> <td>SD1</td> <td>2150</td> <td>2450X2150</td> <td>CG AS PER ELEVATION</td> </tr> <tr> <td>PCD</td> <td>2150</td> <td>1100X2150</td> <td></td> </tr> <tr> <td>GD1</td> <td>2400</td> <td>1300X2400</td> <td></td> </tr> <tr> <td>GD2</td> <td>5400</td> <td>1600X2400</td> <td></td> </tr> </tbody> </table>	NO.	SILL	LINTEL	SIZE	SD1	2150	2450X2150	CG AS PER ELEVATION	PCD	2150	1100X2150		GD1	2400	1300X2400		GD2	5400	1600X2400	
NO.	SILL	LINTEL	SIZE																																																						
D1	7140	1500X2150	W1 900 2150 1500X1250																																																						
D2	2150	1100X2150	W2 900 2150 900X1250																																																						
D3A	2150	1100X2150	W3A 900 2150 1025X1250																																																						
D3B	100	2250	1100X2150																																																						
D3C	2150	900X2150	W4 900 2150 600X1250																																																						
D4	2150	800X2150	W5 300 2400 900X1700																																																						
D4A	2150	600X2150	W6 300 2400 900X2100																																																						
D5	2150	750X2150	W 1550 2150 600X600																																																						
NO.	SILL	LINTEL	SIZE																																																						
SD1	2150	2450X2150	CG AS PER ELEVATION																																																						
PCD	2150	1100X2150																																																							
GD1	2400	1300X2400																																																							
GD2	5400	1600X2400																																																							
UNDERTAKING																																																									
UNDERSIGNED HAS INSPECTED THE SITE AND CARRIED OUT SOIL INVESTIGATION THEREON. IT IS CERTIFIED THAT THE EXISTING JOB OF THE SITE IS ABLE TO CARRY THE LOAD COMING FROM THE PROPOSED CONSTRUCTION AND THE FOUNDATION SYSTEM PROPOSED HEREIN IS SAFE & STABLE IN ALL RESPECT FROM GEO-TECHNICAL POINT OF VIEW.																																																									
 RAJEN KOLEY Geo. Technical Engineer, Class - I IMC, Employment No. 408 Ph. No. 7880125808 9839145895 Email: rajen@rajensh.com																																																									
SIGNATURE OF GEOTECH ENGINEER																																																									
1. I AS A GEO ARCHITECT AND F.E. DURING CONSTRUCTION 2. I FOLLOWED THE INSTRUCTIONS OF ARCHITECT AND E.E. DURING CONSTRUCTION OF THE BUILDING. 3. GEO. AUTHORITY WILL NOT BE RESPONSIBLE FOR STRUCTURE STABILITY OF BUILDING AND FOUNDING STRUCTURE. 4. IF ANY SUBMITTED DOCUMENT IS FOUND TO BE FAKE THE H.M.C. AUTHORITY MAY REVOKE THE SANCTION PLAN. 5. THE CONSTRUCTION OF WATER RESERVOIR AND SEPTIC TANK EXECUTED UNDER THE GUIDANCE OF ARCHITECT & E.E. 6. THE GARDEN AREA WILL BE CONSTRUCTED / MADE AND MAINTAINED BY US AT OUR OWN COST.																																																									
PRM BEGRAJ VENTURES LLP PARTNER SIGNATURE OF OWNERS PRM BEGRAJ VENTURES LLP, represented by its Partner SRI UMANG MITTAL																																																									
THE U.S.A. HAS CERTIFIED ON THE PLAN WITH FULL RESPONSIBILITY THAT THE BUILDING PLAN HAS BEEN DRAWN UP AS PER PROVISION OF H.M.C. B.O.C. RULES 2009 AS AMENDED FROM TIME TO TIME AND THAT THE SITE CONDITION INCLUDING THE WIDTH OF THE BUILDING ROAD COMPARE WITH THE PLAN AND IT IS A BUILDABLE SITE AND NOT A TANK OR A FILLED UP TANK.																																																									
 KARUNAMOY KOLAY Regd. Architect Regn. No. - CA/2003/32287																																																									
SIGNATURE OF ARCHITECT																																																									
THE STRUCTURAL DESIGN OF BOTH FOUNDATION AND SUPERSTRUCTURE OF THE BUILDING HAVE BEEN MADE BY ME CONSIDERING ALL POSSIBLE LOADS INCLUDING THE SEISMIC LOAD AS PER H.M.C. OF INDIA AND CERTIFY THAT IT IS SAFE AND STABLE IN ALL RESPECT THE RECOMMENDATION OF SOIL REPORT HAS BEEN CONSIDERED DURING STRUCTURAL CALCULATION.																																																									
 S. S. V. PARIKH M.E. (STRUCT.), M.E. (CONST. ENG.), I.C.E., FIE (F-018202-4) E. S. E. No. 104 (I) K. M. C.																																																									
SIGNATURE OF STRUCTURAL ENGINEER																																																									
S. S. V. PARIKH BSC, B.E., FIE (F-116554-5) CHARTERED ENGINEER ENLISTED STRUCTURAL REVIEWER 88716 K.M.C.																																																									
SIGNATURE OF STRUCTURAL REVIEWER																																																									
Pratik Kumar Deb Pratik Kumar Deb CIVIL (B. Tech) LBS-1 Regn. No. - EBM/EV/PAL159 COUNTER SIGNED BY:																																																									
COUNTER SIGNED BY:																																																									
TITLE: TOWER-2 ROOF & ABOVE ROOF PLAN																																																									
PRINCIPAL ARCHITECT: BEYOND ARCHITECTURE PLANNING STUDIO PVT. LTD. Regd. Office: 117A/16 SARAI GHOSH GARDEN ROAD, KOLKATA - 700031 www.beyondarchitecture.co.in																																																									
DRAWN BY- SS DESIGN KODE ARCHITECTS Designer, Eastern Bypass, Singur +91 9634055345, +91 9817733330 d.kode.in@gmail.com																																																									
CKD BY- TM																																																									
FILE NO. SCALE SHEET NO. DATE 1:100 11 16.07.2022																																																									
SPACE FOR OFFICE USE:																																																									
 Assistant Engineer Cooch Behar Zilla Parishad Cooch Behar																																																									
 Sub-Assistant Engineer Cooch Behar Zilla Parishad Cooch Behar																																																									
 District Engineer Cooch Behar Zilla Parishad Cooch Behar																																																									
SHEET SIZE 750X600																																																									